



REQUEST FOR QUOTATION

The Bureau of Customs (BOC), through its Administration Office (AO), will undertake a Small Value Procurement for **Repair/Rehabilitation of Revenue Accounting Division**, in accordance with the Revised Implementing Rules and Regulations of Republic Act No. 9184. The details of the project are as follows:

Name of Project : **Repair/Rehabilitation of Revenue Accounting Division**
 Location : **Revenue Accounting Division, CRIC Building, BOC**
 Approved Budget for the Contract: **Four Hundred Ninety Five Thousand One Hundred Four Pesos (Php495,104.00), inclusive of tax**

Specifications :

Qty.	Unit	DESCRIPTION
		A. ARCHITECTURAL AND ELECTRICAL WORKS
		I. Dismantling/Restoration and Hauling-Out Works
1	lot	1. Dismantling of dilapidated ceiling at ground floor and mezzanine
1	lot	2. Dismantling of roofing including framing at Statistic Division Mezzanine
1	lot	3. Dismantling of electrical rough-ins
1	lot	4. Restoration of all affected areas
1	lot	5. Cleaning of site and hauling-out of debris/wastes
		II. Carpentry
1	lot	1. Repair of Cabinet/Shelf
		III. Ceiling Works
128.59	sqm	1. 4.50mm thk cement fiberboard ceiling on 0.40mm thk x 19mm x 25mm furring channel @ 0.40mm o.c. and 1.00mm thk x 12mm x 38mm carrying channel with 1.20m O.C. B.W with adjustable rod hanger at Pantry, CRs and mezzanine
74.89	lm	2. Wooden cornice
		IV. Painting
395.35	sq. m	1. Semi-gloss latex paint finish for internal wall
262.72	sq. m	2. Flatwall enamel paint finish for Cement fiberboard ceiling
171.89	lm	3. Semi-gloss enamel paint finish for wooden cornice
		V. Roofing
69.12	sq. m	1. Prepainted long span, Rib Type G.I sheet G.A #24 pacific blue w/ complete accessories such as ridge, gutter, flushing, insulation and accessories
1	lot	2. Roof framing
		VI. Electrical Works
		1. Lighting fixtures and accessories
10	pcs	a. 1 x 18 watts daylight PL Lamp 6" diameter pin light diamond design reflector recessed mounted
20	pcs	b. Fluorescent lamp T5 daylight 21 W
		2. Wires
2	boxes	a. 3.5 sq. mm THHN copper wire stranded

3	rolls	3. Roughing-Ins and accessories a. 25 mm diameter PVC flexible conduit pipe
46	pcs	4. Box a. Junction box

Delivery Term: Fifty (50) calendar days from signing of PO

Interested contractors are required to submit their valid and current Mayor's Permit, DTI/SEC Registration, PHILGEPS Registration Certificate, PCAB License (minimum required Small A), List of Key personnel and duly signed price quotation form (Annex "A").

Submission of quotation and eligibility documents is on or before September 16, 2016, 10:00 a.m., at General Services Division (GSD), Ground Floor, OCOM Building, Port Area, Manila.

Award of contract shall be made to the lowest quotation, which complies with the minimum description as stated above and other terms and conditions stated in the price quotation form.

Any interlineations, erasures or overwriting shall be valid only if they are signed or initialed by the bidder or his/her duly authorized representative/s.

The BOC reserves the right to accept or reject any or all quotations and to impose additional terms and conditions as it may deem proper.

For inquiry, you may contact us at Telefax no. 527-9757 or email us at bacsecretariat@customs.gov.ph.

Very truly yours,

ARTURO M. LACHICA, CESO II
Deputy Commissioner, IAG

Annex "A"

PRICE QUOTATION FORM

Date: _____

The Bids and Awards Committee
Bureau of Customs
Port Area, Manila

Sir/Madam:

After having carefully read and accepted the terms and conditions in the Request for Quotation, hereunder is our quotation/s for the items as follows:

Qty.	Unit	DESCRIPTION	Unit Price	Total Price
		A. ARCHITECTURAL AND ELECTRICAL WORKS		
1	lot	I. Dismantling/Restoration and Hauling-Out Works		
1	lot	1. Dismantling of dilapidated ceiling at ground floor and mezzanine		
1	lot	2. Dismantling of roofing including framing at Statistic Division Mezzanine		
1	lot	3. Dismantling of electrical rough-ins		
1	lot	4. Restoration of all affected areas		
1	lot	5. Cleaning of site and hauling-out of debris/wastes		
1	lot	II. Carpentry		
		1. Repair of Cabinet/Shelf		
128.59	sqm	III. Ceiling Works		
		1. 4.50mm thk cement fiberboard ceiling on 0.40mm thk x 19mm x 25mm furring channel @ 0.40mm o.c. and 1.00mm thk x 12mm x 38mm carrying channel with 1.20m O.C. B.W with adjustable rod hanger at Pantry, CRs and mezzanine		
74.89	lm	2. Wooden cornice		
395.35	sq. m	IV. Painting		
262.72	sq. m	1. Semi-gloss latex paint finish for internal wall		
		2. Flatwall enamel paint finish for Cement fiberboard ceiling		
171.89	lm	3. Semi-gloss enamel paint finish for wooden cornice		
69.12	sq. m	V. Roofing		
		1. Prepainted long span, Rib Type G.I sheet G.A #24 pacific blue w/ complete accessories such as ridge, gutter, flushing, insulation and accessories		
1	lot	2. Roof framing		
		VI. Electrical Works		

10	pcs	1. Lighting fixtures and accessories a. 1 x 18 watts daylight PL Lamp 6" diameter pin light diamond design reflector recessed mounted		
20	pcs	b. Fluorescent lamp T5 daylight 21 W		
2	boxes	2. Wires a. 3.5 sq. mm THHN copper wire stranded		
3	rolls	3. Roughing-Ins and accessories a. 25 mm diameter PVC flexible conduit pipe		
46	pcs	4. Box a. Junction box		

Warranty : ____ months from the date of delivery

Total amount in words:

The above-quoted prices are inclusive of all costs and applicable taxes.

Very truly yours,

Name/ Signature of Representative

Name of Company

Mayor's Permit No. _____

PhilGEPS Registration No. _____

DTI/SEC Certificate No. _____

(Please submit the photocopies of the above documents upon submission of quotation)



RA 545 ART. 2 SEC. 25 (4)
 ALL DESIGNS, DRAWINGS, SPECIFICATIONS, AND COPIES THEREOF, PREPARED AND FORWARDED BY THE ARCHITECT IN CONNECTION WITH THE CONTRACT FOR THE ARCHITECT'S SERVICES, SHALL BE THE PROPERTY OF THE ARCHITECT UNLESS OTHERWISE SPECIFIED AND THE ARCHITECT WILL BE RESPONSIBLE FOR THE WORK WHICH THEY ARE USED FOR OTHER WORK EXCEPT BY THE WRITTEN AGREEMENT WITH THE ARCHITECT.

ARCHITECT	ENGINEER
FILE NO.	FILE NO.
DATE	DATE
SCALE	SCALE

PROJECT TITLE:
REPAIR/IMPROVEMENT OF REVENUE ACCOUNTING DIVISION

OWNER:
BUREAU OF CUSTOMS

SHEET CONTENT:	A
	B
	C
	D

DRAWN BY:
GENEVA S. GIBSON
 BOUTSIAN, BOO-CSD

SHEET NO.

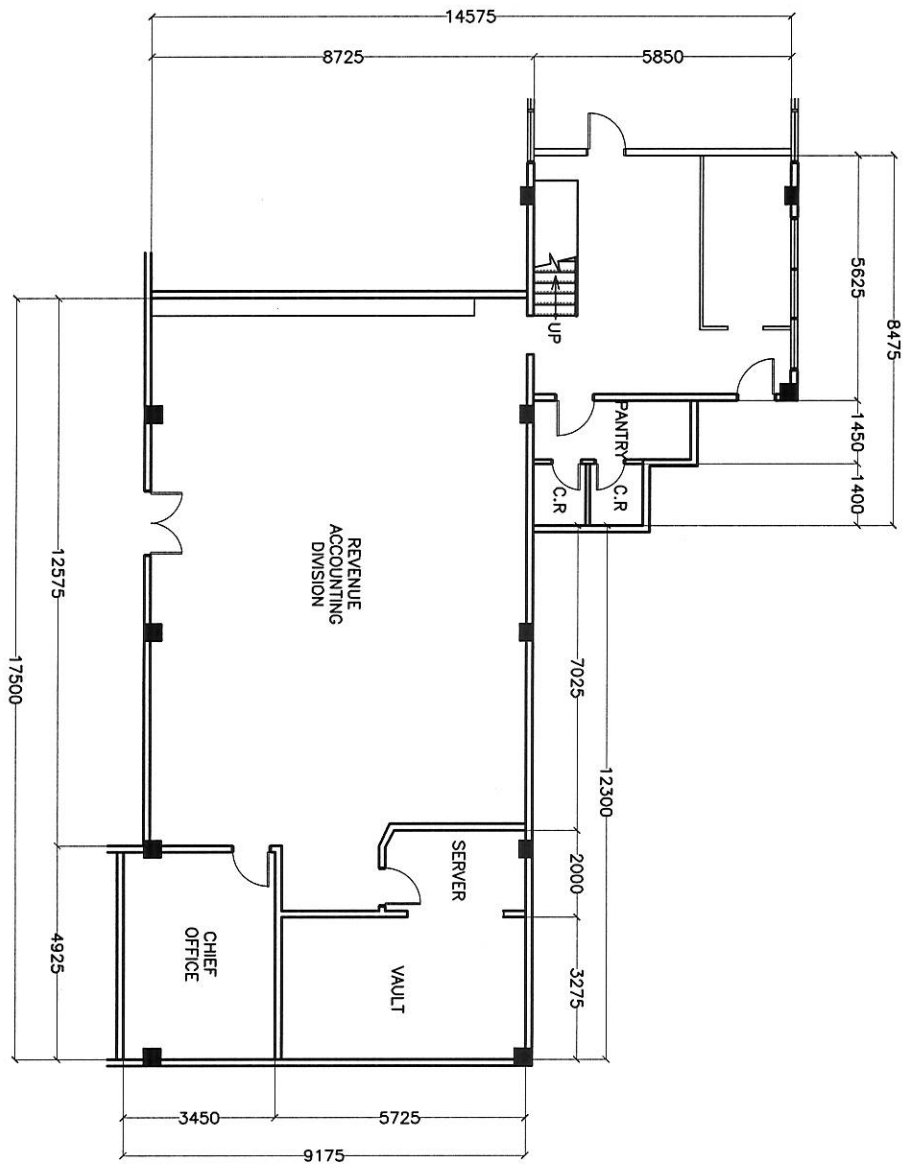

EXISTING FLOOR PLAN
 NOT TO SCALE

